

BASO 4.0 DIRECT



CERTIFICATIONS & COMPLIANCE



FEATURES



PERFORMANCE

- Up to 111lm/W efficiency
- 500 / 955 lm/ft
- CRI > 80 & CRI > 90
- IC & Damp rated

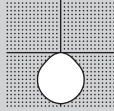

MOUNTING

Recessed

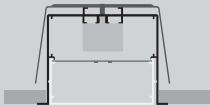

PATTERNS



*X Shapes Angular Curves Rectangular *T Shapes *Wall to Ceiling

For customization, please contact customer service

FIELD-CUTTABLE FLEX

Down to 1/16"



[link to video](#)

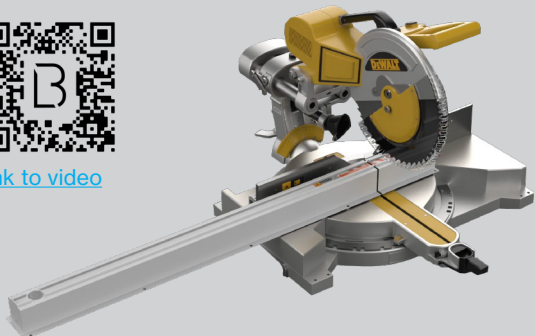

Catalog Number Example

BASO 4.0-RTL-BL-OP-30K-C80-UNV-010V-0500LF-ST-24IN

A B C D E F G H J L M

A RANGE

BASO 4.0 BASO4 . 0

B MOUNTING

CS Recessed trimless	RTL
CS Recessed with trim	TR
CS Armstrong Suprafine 9/16" G	A9G
CS Armstrong Interlude 9/16" SG	A9S
CS Armstrong Silhouette 9/16" BSG	A9S
CS Armstrong Prelude 15/16" G	A15
CS 9/16" Grid (any brand)	9GR
CS 9/16" Slot Grid (any brand)	9SG
CS 15/16" Grid (any brand)	15G
Custom	XXX

C COLOR

CS White	WH
CS Black	BL
Gray	GR
Custom color RAL	XX

trimless version available in white only

D LENS

HP opal cover OP

E CCT

2700K	27K
CS 3000K	30K
CS 3500K	35K
4000K	40K

F CRI

CRI > 80 C80
CRI > 90 C90

G VOLTAGE

120V/277V UNV

H DIMMING

CS 0-10V 1%	010V
Lutron EcoSystem	LES1
Quantum, Vive, GRAFIK Eye, HomeWorks	
Power over ethernet	POEC
consult customer service for compatibility	
Custom dimming	XXX
consult customer service for compatibility	

I SENSOR (optional)

Integrated Sensor SEN
consult customer service for sensor request

J OUTPUT LM/FT

CS 500lm/ft 100% ↓	0500LF
CS 750lm/ft 100% ↓	0750LF
CS 1000lm/ft 100% ↓	1000LF
Custom lm/ft	XXXXLF

custom lumen up to 1400 lm/ft

K CIRCUIT / EM

CS Single circuit	*
EMC night light circuit	NLC
EMB available in 4ft and 8ft	EM#

* leave blank

L SHAPE / PATTERN

CS Linear / straight	ST
CS Linear / straight + flex inset	SF

includes 1ft. field-cutable section; only available for 4' and 8' segments

L-shape	LS
□-shape (rectangular shape)	RS
U-shape	US
Custom shape	XX

for grid applications using L-shape, rectangular shape or U-shape, please contact customer service for availability

M DIMENSIONS IN INCH

Linear 2'	24IN
CS Linear 4'	48IN
CS Linear 6'	72IN
CS Linear 8'	96IN
Linear custom	###IN
Linear flex inset	###IN

field-cutable section

L-Shape	###X###IN
U-Shape	###X###X###IN
□-Shape	###X###IN

for lengths including flex insets, round up to the nearest total foot length

N CERTIFICATION (optional)

Chicago Plenum CCEA
Red List Approved RLA

Technical data

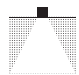
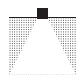
	SIZE TYPE	LED COLOR TEMPERATURE	INPUT WATTS	DELIVERED LM TOTAL	LIGHT DISTRIBUTION	DELIVERED LM DIRECT	DELIVERED LM INDIRECT	OPTICAL EFFICIENCY	LUMINAIRE EFFICACY	
BASO DIRECT										
	e LED	2' linear	40K	9W	910lm	100% down	500 lm/ft	-	76%	111lm/W
		4' linear		18W	2000lm					
		6' linear		27W	3000lm					
		8' linear		36W	4000lm					
		2' + 2' corner		18W	2000lm					
	e² LED	2' linear	40K	18W	1910lm	100% down	955 lm/ft	-	76%	106lm/W
		4' linear		36W	3820lm					
		6' linear		54W	5730lm					
		8' linear		72W	7640lm					
		2' + 2' corner		36W	3820lm					

for 30K or 35K multiply lm value by 0.96

Patterns top view

LINEAR

A	FIXTURES	CODE
48"	1 × 4' linear	ST - 0 4 FT
96"	1 × 8' linear	ST - 0 8 FT
144"	3 × 4' linear	ST - 1 2 FT

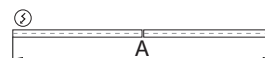

L-SHAPE

A / B	FIXTURES	CODE
48" / 48"	2 × 2' linear + 1 × 2' × 2' corner	LS - 0 4 X 0 4 FT
48" / 96"	1 × 2' linear + 1 × 6' linear + 1 × 2' × 2' corner	LS - 0 4 X 0 8 FT
96" / 96"	2 × 6' linear + 1 × 2' × 2' corner	LS - 0 8 X 0 8 FT

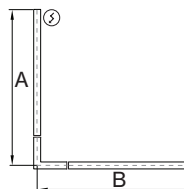

□-SHAPE (rectangular shape)

A / B	FIXTURES	CODE
48" / 48"	4 × 2' × 2' corner	RS - 0 4 X 0 4 FT
48" / 96"	2 × 4' linear + 4 × 2' × 2' corner	RS - 0 4 X 0 8 FT
96" / 96"	4 × 4' linear + 4 × 2' × 2' corner	RS - 0 8 X 0 8 FT

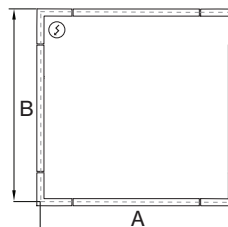

U-SHAPE

A / B / C	FIXTURES	CODE
48" / 48" / 48"	2 × 2' linear + 2 × 2' × 2' corner	US - 0 4 X 0 4 X 0 4 FT
48" / 96" / 48"	1 × 4' linear + 2 × 2' linear + 2 × 2' × 2' corner	US - 0 4 X 0 8 X 0 4 FT
48" / 144" / 48"	1 × 8' linear + 2 × 2' linear + 2 × 2' × 2' corner	US - 0 4 X 1 2 X 0 4 FT

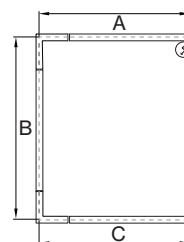

DIMENSIONS

BASO 4.0

RECESSED trimless

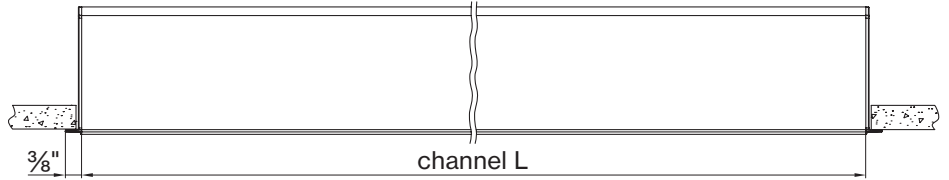
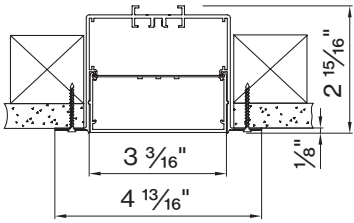

RECESSED with trim

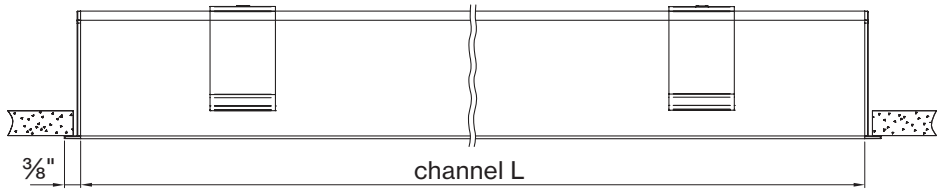
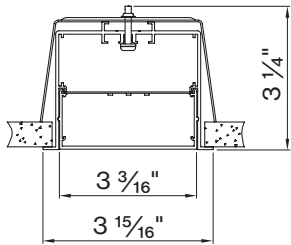

1/16" T-GRID

1/16" Slot Grid (any brand)

1/16" Grid (any brand) 4ft / 15/16" Grid

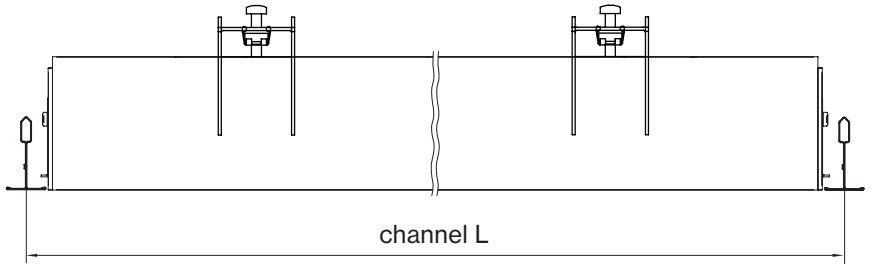
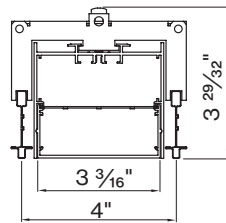
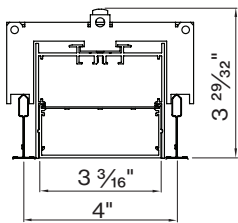

15/16" T-GRID

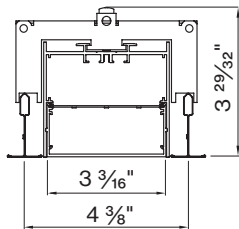

Declare.

BASO 1.5 2.5 4.0
BASO Inc.

Final Assembly: Collins, Connecticut, USA
 LBN (Manufacturing) 718480
 End of Life Options: Recyclable (B7%), Landfill (20%)

Ingredients:
 Aluminum, Phosphoric acid, 2-methyl-, methyl ester, octylmer, ethylhexyl, 2-oxo-2-phenylpropane, steel, manufacture, chemicals, Copper, channel, Cu2O, steel, mounting, components, Polypropylene, glass, 11-, titanium, 2-amine-, 2-hydroxyethyl-, Chloride, Stainless Steel, Tin, Organic Silicon

1. LBC Temp Exception RECO2 - Small Electrical Components

Living Building Challenge Criteria Compliance

H3 Red List:
 ■ LBC Red List Free ■ Disposed 100% at 100ppm Chloride
 ■ LBC Red List Approved ■ VOC Content: Not Applicable

H0 Interior Performance: Not Applicable
H4 Responsible Sourcing: Not Applicable

BAS-0002
 8/01/2022 (2025)
 Original Issue Date: 2023

INTERNATIONAL LIVING FUTURE MATTER™ Living Building Challenge

BASO mounting instructions

Get access to the BASO 4.0 mounting instructions faster by scanning the QR code.

<https://www.basolighting.com/resources/mounting-instructions/baso>

